

### Standard Specifications

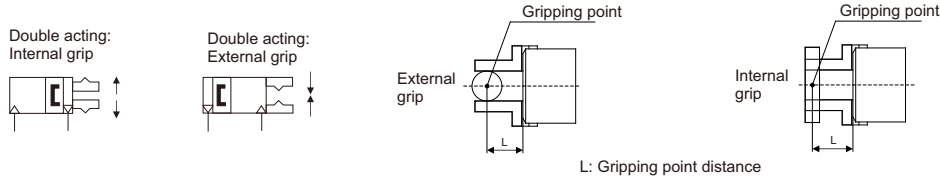

Model	NMHS2-16D	NMHS2-20D	NMHS2-25D	NMHS2-32D	NMHS2-40D	NMHS2-50D	NMHS2-63D
Bore size(mm)	16	20	25	32	40	50	63
Fluid	Air						
Operating pressure(MPa)	0.2~0.6MPa			0.1~0.6MPa			
Ambient and fluid temperature(°C)	-10~60°C(Not frozen)						
Repeatability(mm)	±0.01mm						
Max. operating frequency(c.p.m)	120c.p.m			60c.p.m			
Lubrication	Not required						
Action	Double acting						
Effective gripping force (N) at 0.5 MPa	External grip	21	37	63	111	177	280
	Internal grip	23	42	71	123	195	306
Opening/Closing stroke (Both sides)(mm)	4	4	6	8	8	12	16
Weight(g)	58	96	134	265	345	515	952

### Standard Specifications

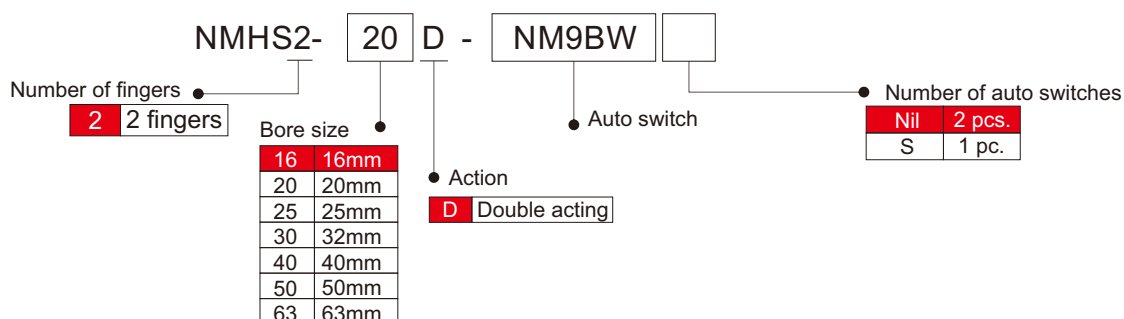

### Effective Gripping Force

External Grip

NMHS2-16D

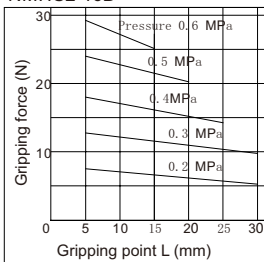

NMHS2-20D

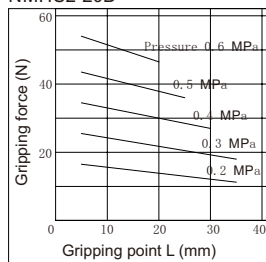

NMHS2-25D

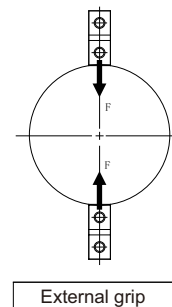
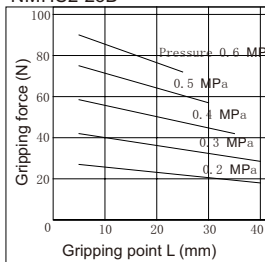

Internal Grip

NMHS2-16D

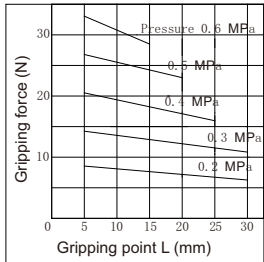

NMHS2-20D

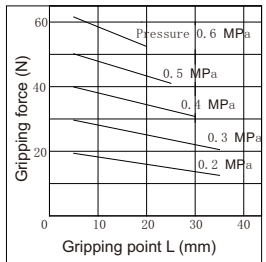

NMHS2-25D

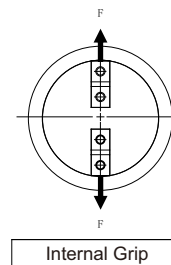
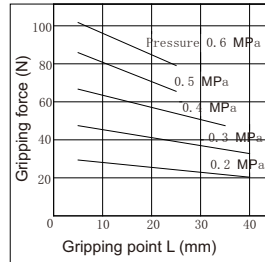

External Grip  
NMHS2-32D

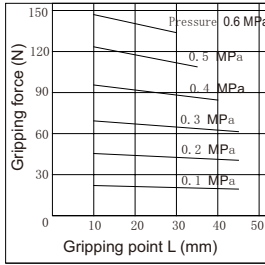

NMHS2-40D

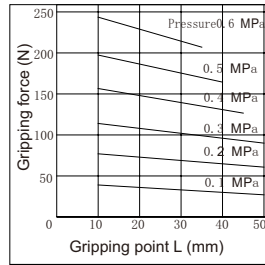

NMHS2-50D

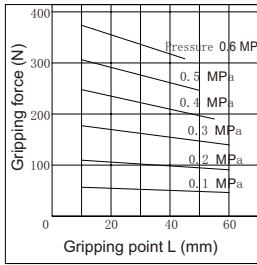

NMHS2-63D

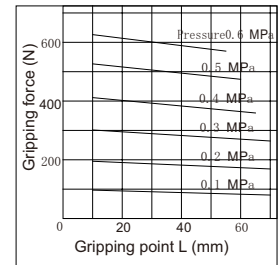

Internal Grip  
NMHS2-32D

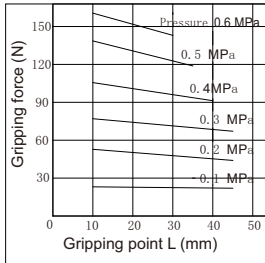

NMHS2-40D

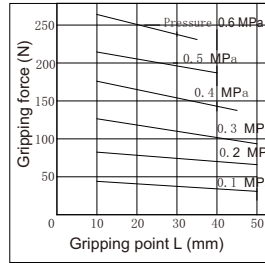

NMHS2-50D

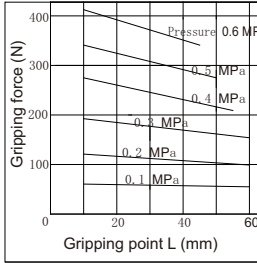

NMHS2-63D

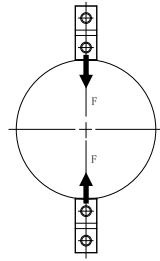
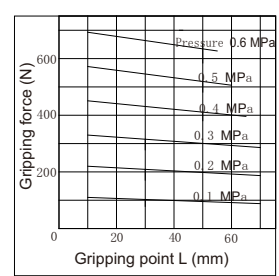

External grip

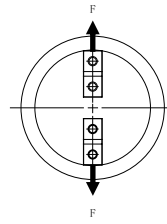

Internal grip

### NMHS2-□(Φ16)

2 x  $\phi 3.4$  through  
6.5 Counterbore depth SC (Mounting Hole)

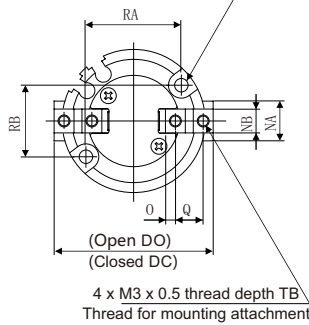

4 x M3 x 0.5 thread depth TB  
Thread for mounting attachment

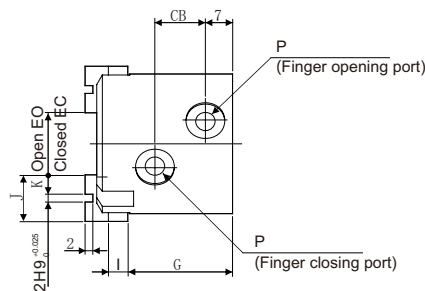
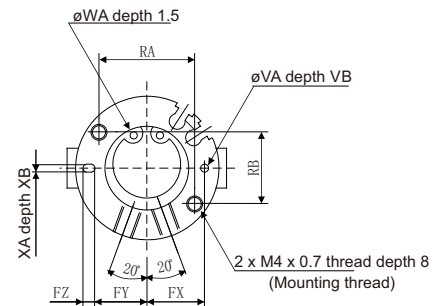
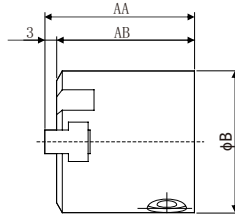

### NMHS2 -16D to 25D

(mm)

Model	AA	AB	B	CB	DC	DO	EC	EO	FX	FY	FZ	G	I	J	K	NA
NMHS2-16D	35	32	30	11	30	34	10	14	12.5	11	3	25	4	10	4	8
NMHS2-20D	38	35	36	13	36	40	12	16	14.5	13	3	27	5	12	5	10
NMHS2-25D	40	37	42	15	42	48	14	20	17	14.5	5	28	5	14	6	12

  

Model	NB	O	P	Q	RA	RB	SC	TB	XA	VB	WA	VA	XB
NMHS2-16D	5h9 <sub>0</sub> <sup>-0.030</sup>	2	M3 x 0.5	6	18	16	8	5	2H9 <sub>0</sub> <sup>+0.025</sup>	2	17H9 <sub>0</sub> <sup>+0.043</sup>	2H9 <sub>0</sub> <sup>+0.025</sup>	2
NMHS2-20D	6h9 <sub>0</sub> <sup>-0.030</sup>	2.5	M5 x 0.8	7	24	18	9.5	6	2H9 <sub>0</sub> <sup>+0.025</sup>	2	21H9 <sub>0</sub> <sup>+0.052</sup>	2H9 <sub>0</sub> <sup>+0.025</sup>	2
NMHS2-25D	6h9 <sub>0</sub> <sup>-0.030</sup>	3	M5 x 0.8	8	26	22	10	6	3H9 <sub>0</sub> <sup>+0.025</sup>	3	26H9 <sub>0</sub> <sup>+0.052</sup>	3H9 <sub>0</sub> <sup>+0.025</sup>	3

### NMHS2-□(Φ25)

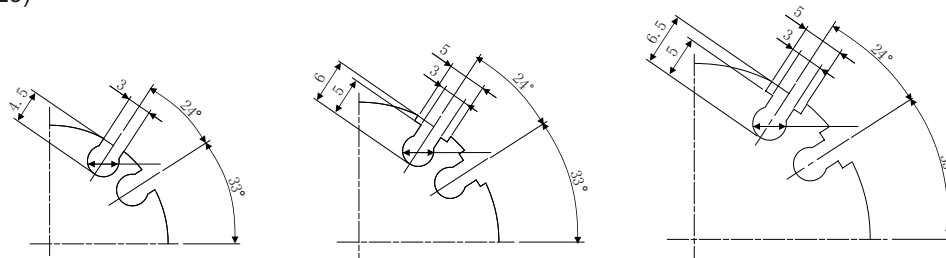

### NMHS2-□(Φ32/Φ40)

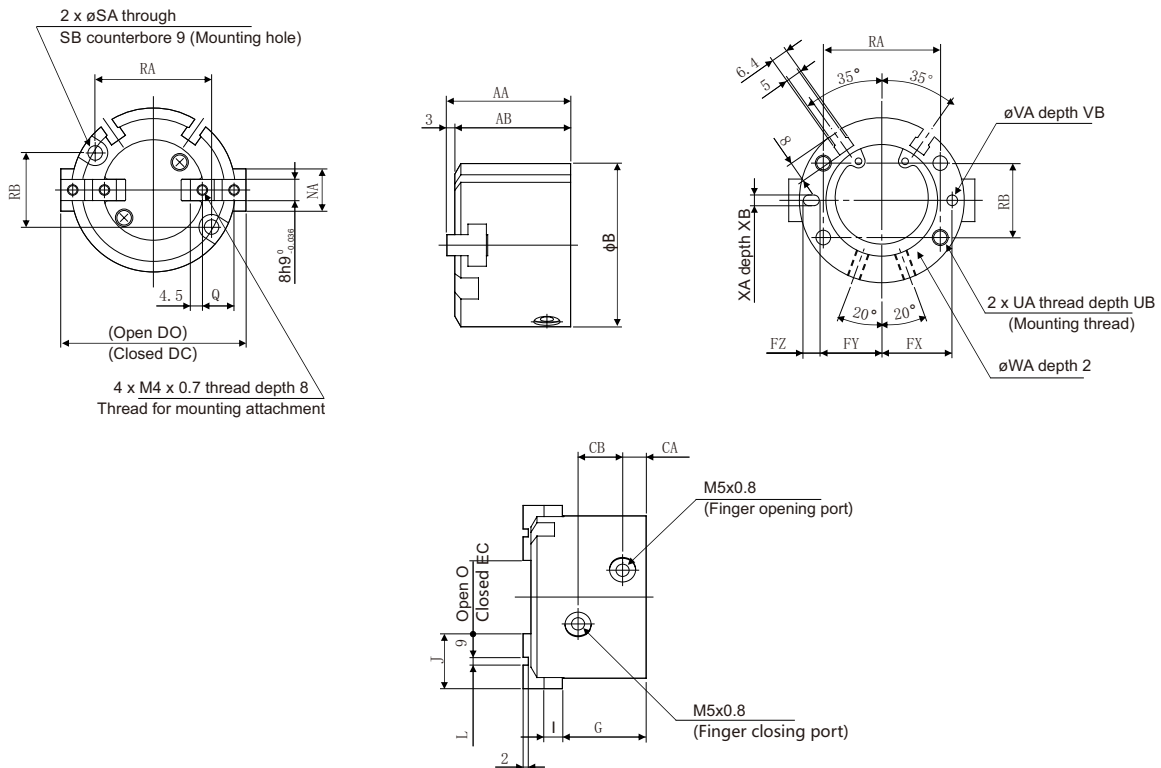

(mm)

Model	AA	AB	B	CA	CB	DC	DO	EC	EO	FX	FY	FZ	G	I	J	L
NMHS2-32D	44	41	56	8	16	56	64	16	24	23	20.5	5	30.5	6	20	2H9 <sub>0</sub> <sup>+0.025</sup>
NMHS2-40D	47	44	62	9	17	62	70	20	28	26.5	23.5	6	32	7	21	3H9 <sub>0</sub> <sup>+0.025</sup>

Model	NA	Q	RA	RB	SA	SB	UA	UB	VA	VB	WA	XA	XB
NMHS2-32D	14	11	38	25	4.5	8	M5 x 0.8	10	3H9 <sub>0</sub> <sup>+0.025</sup>	3	34H9 <sub>0</sub> <sup>+0.062</sup>	3H9 <sub>0</sub> <sup>+0.025</sup>	3
NMHS2-40D	16	12	44	28	5.5	9.5	M6 x 1	12	4H9 <sub>0</sub> <sup>+0.030</sup>	4	42H9 <sub>0</sub> <sup>+0.062</sup>	4H9 <sub>0</sub> <sup>+0.030</sup>	4

### NMHS2-□(Φ50/Φ63)

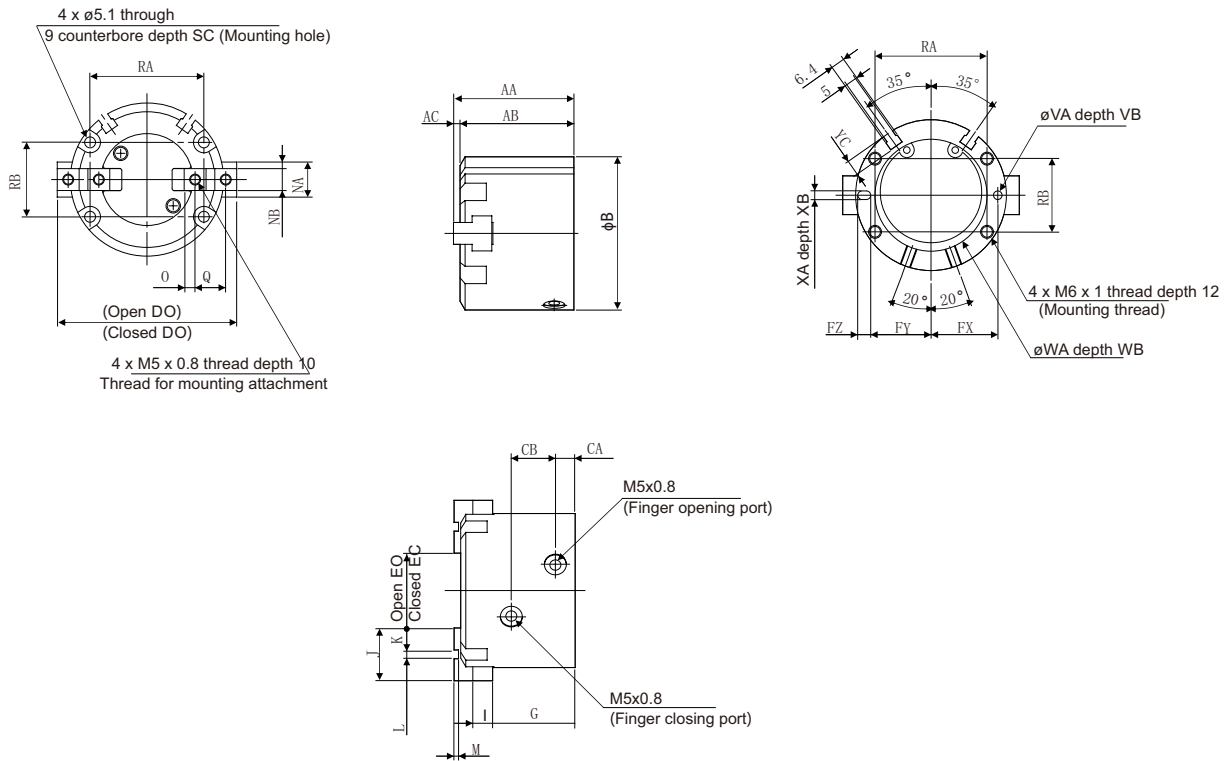

(mm)

Model	AA	AB	AC	B	CA	CB	DC	DO	EC	EO	FX	FY	FZ	G	I	J	K	L	M
NMHS2-50D	55	52	3	70	9	20	70	82	22	34	31	28	6	37,5	9	24	10	4H9 <sup>+0.030</sup> <sub>0</sub>	2
NMHS2-63D	66	62	4	86	12	22	86	102	30	46	38	34.5	7	44	11	28	11	6H9 <sup>+0.030</sup> <sub>0</sub>	3

Model	NA	NB	O	Q	RA	RB	SC	VA	VB	WA	WB	XA	XB	YC
NMHS2-50D	18	10H9 <sup>0</sup> <sub>-0.036</sub>	5	14	52	34	12	4H9 <sup>+0.030</sup> <sub>0</sub>	4	52H9 <sup>+0.074</sup> <sub>0</sub>	2	4H9 <sup>+0.030</sup> <sub>0</sub>	4	7
NMHS2-63D	24	12H9 <sup>0</sup> <sub>-0.036</sub>	5.5	17	66	38	14	5H9 <sup>+0.030</sup> <sub>0</sub>	5	65H9 <sup>+0.074</sup> <sub>0</sub>	2.5	5H9 <sup>+0.030</sup> <sub>0</sub>	5	7.5

### NMHS2 Dimensions

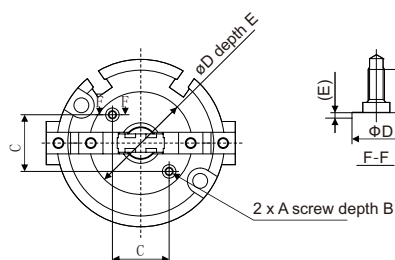

(mm)

Model	A	B	C	øD	E
NMHS2-16D	M2 x 0.4	5.5	11	21 <sup>+0.1</sup> <sub>0</sub>	0.5
NMHS2-20D		5.4	13	24 <sup>+0.1</sup> <sub>0</sub>	0.6
NMHS2-25D			15	27 <sup>+0.1</sup> <sub>0</sub>	
NMHS2-32D	M3 x 0.5	5.2	18	32 <sup>+0.1</sup> <sub>0</sub>	0.8
NMHS2-40D		8	21	38 <sup>+0.1</sup> <sub>0</sub>	1
NMHS2-50D			24	42 <sup>+0.1</sup> <sub>0</sub>	
NMHS2-63D			32	54 <sup>+0.1</sup> <sub>0</sub>	