

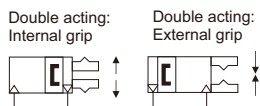

Standard Specifications

Model	NMHS4-16D	NMHS4-20D	NMHS4-25D	NMHS4-32D	NMHS4-40D	NMHS4-50D	NMHS4-63D
Cylinder bore size(mm)	16	20	25	32	40	50	63
Fluid	Air						
Operating pressure (Mpa)	0.2~0.6Mpa			0.1~0.6Mpa			
Ambient and fluid temperature (°C)	-10~60°C(Not frozen)						
Repeatability (mm)	±0.01mm						
Max. operating frequency (c.p.m.)	120c.p.m			60c.p.m			
Lubrication	Not required						
Action	Double acting						
Effective gripping force (N) at 0.5 MPa ^{nom}	External grip	10	19	31	55	88	251
	Internal grip	12	21	35	61	97	268
Opening/Closing stroke (mm) (dia.)	4	4	6	8	8	12	16
Weight (g)	66	110	154	300	390	590	1095

Symbol



Standard Specifications

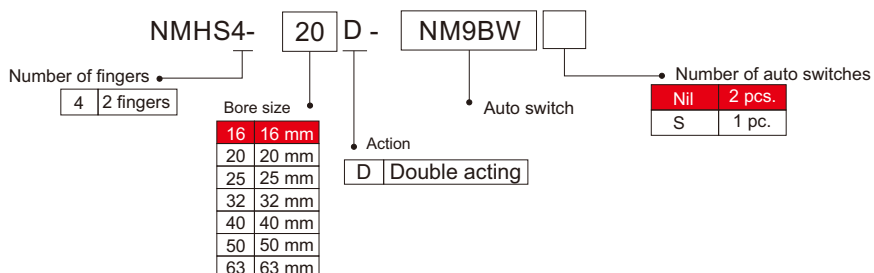

Gripping Point

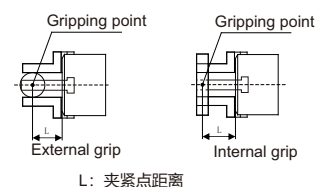

Effective Gripping Force

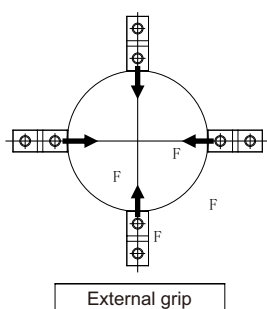

External Grip

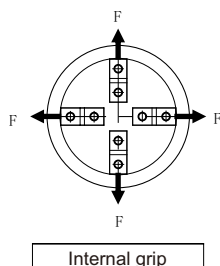
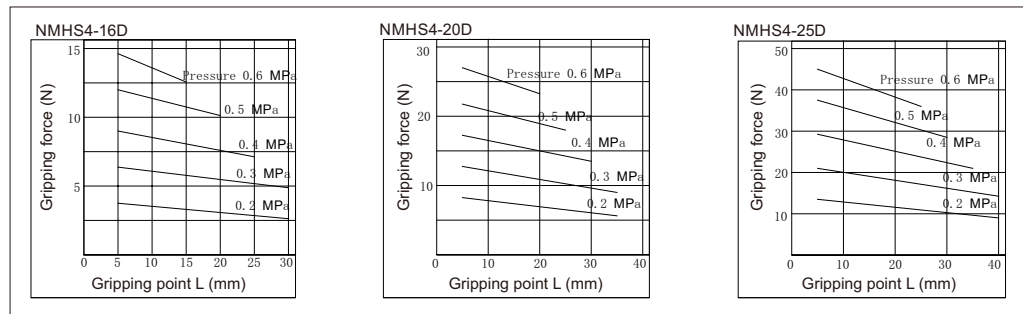

Internal Grip

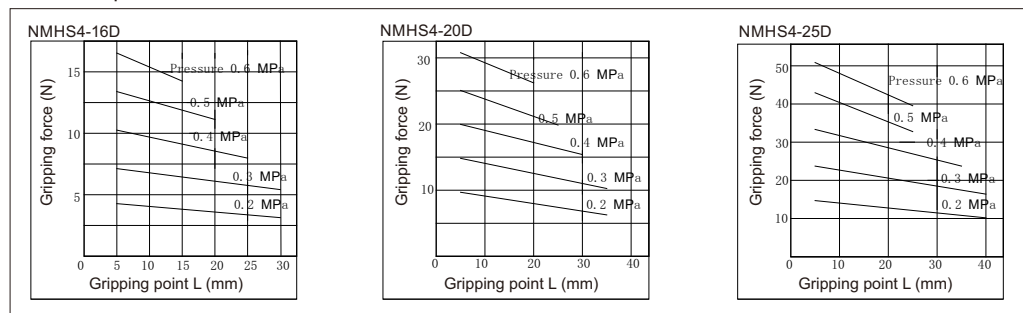

Effective Gripping Force

External Grip

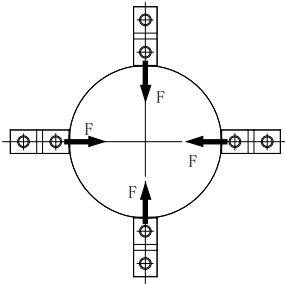

External Grip

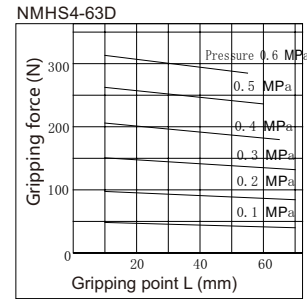
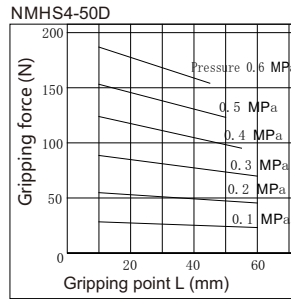
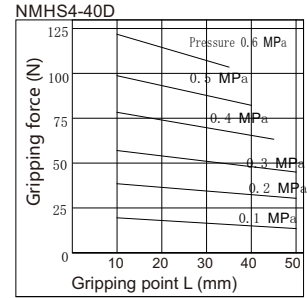
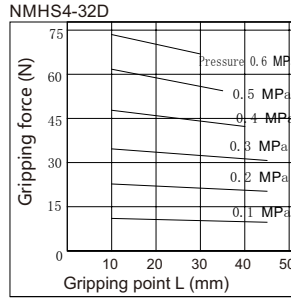

Internal Grip

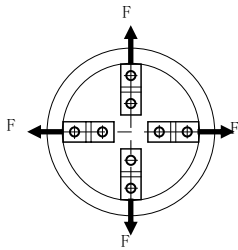

Internal Grip

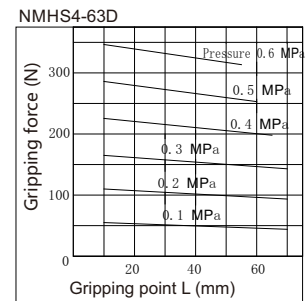
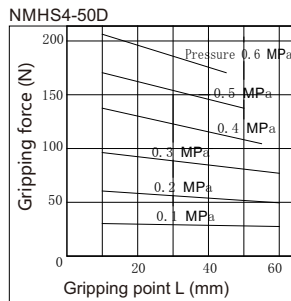
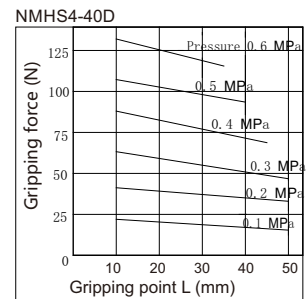
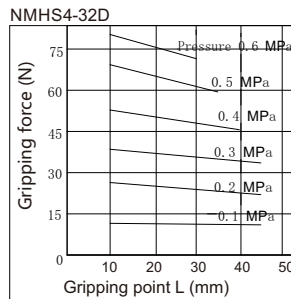

Dimensions

NMHS4-□ Φ16D/Φ25D

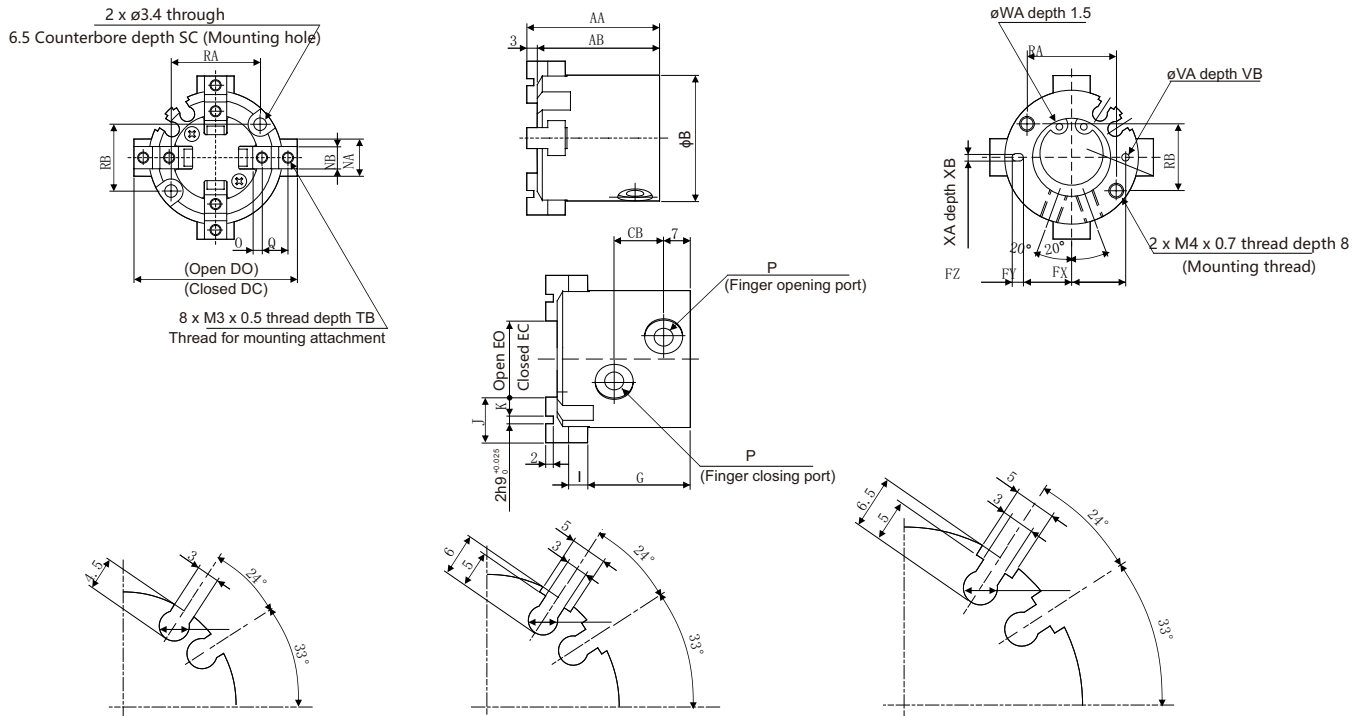

(mm)

Model	AA	AB	B	CB	DC	DO	EC	EO	FX	FY	FZ	G	I	J	K	NA	NB
NMHS4-16D	35	32	30	11	33	37	13	17	12.5	11	3	25	4	10	4	8	5h9 ₀ ⁰ -0.030
NMHS4-20D	38	35	36	13	39	43	15	19	14.5	13	3	27	5	12	5	10	6h9 ₀ ⁰ -0.030
NMHS4-25D	40	37	42	15	48	54	20	26	17	14.5	5	28	5	14	6	12	6h9 ₀ ⁰ -0.030

Model	O	P	Q	RA	RB	SC	TB	VA	VB	XA	XB	WA	XA	VB
NMHS4-16D	2	M3 x 0.5	6	18	16	8	5	2H9 ₀ ^{+0.025}	2	17H9 ₀ ^{+0.043}	2	17H9 ₀ ^{+0.043}	2H9 ₀ ^{+0.025}	2
NMHS4-20D	2.5	M5 x 0.8	7	24	18	9.5	6	2H9 ₀ ^{+0.025}	2	21H9 ₀ ^{+0.052}	2	21H9 ₀ ^{+0.052}	2H9 ₀ ^{+0.025}	2
NMHS4-25D	3	M5 x 0.8	8	26	22	10	6	3H9 ₀ ^{+0.025}	3	26H9 ₀ ^{+0.052}	3	26H9 ₀ ^{+0.052}	3H9 ₀ ^{+0.025}	3

NMHS4-□ Φ32D/Φ40D

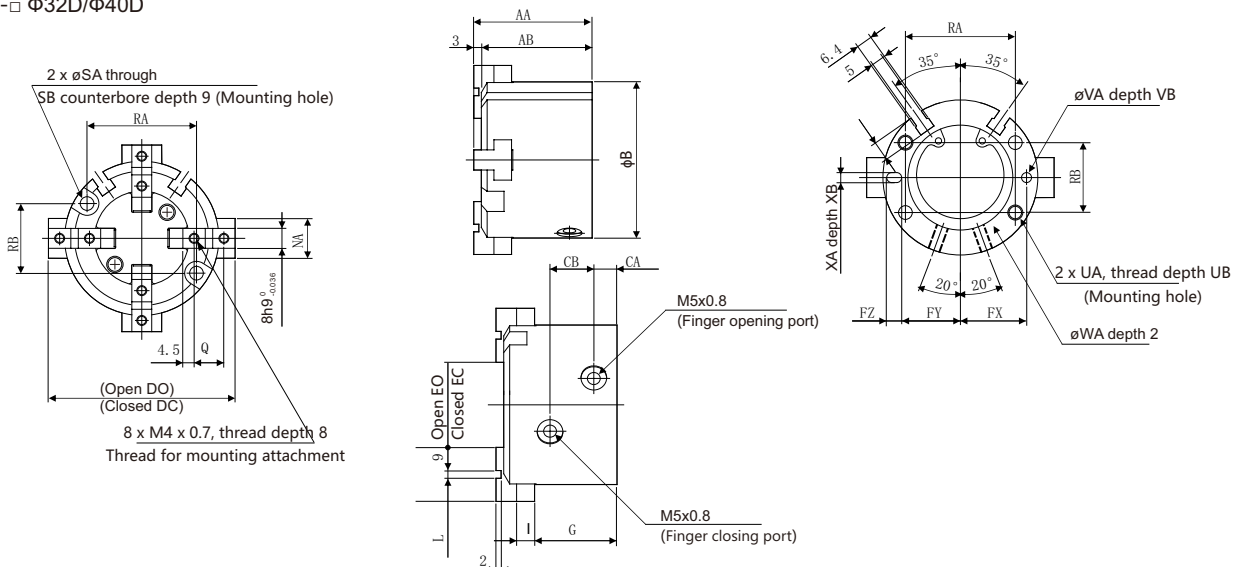

Model	AA	AB	B	CA	CB	DC	DO	EC	EO	FX	FY	FZ	G	I	J	L
NMHS4-32D	44	41	56	8	16	60	68	20	28	23	20.5	5	30.5	6	20	2H9 ₀ ^{+0.025}
NMHS4-40D	47	44	62	9	17	66	74	24	32	26.5	23.5	6	32	7	21	3H9 ₀ ^{+0.025}

Model	NA	Q	RA	RB	SA	SB	UA	UB	VA	VB	WA	XA	XB
NMHS4-32D	14	11	38	25	4.5	8	M5 x 0.8	10	3H9 ₀ ^{+0.025}	3	34H9 ₀ ^{+0.062}	3H9 ₀ ^{+0.025}	3
NMHS4-40D	16	12	44	28	5.5	9.5	M6 x 1	12	4H9 ₀ ^{+0.030}	4	42H9 ₀ ^{+0.062}	4H9 ₀ ^{+0.030}	4

Dimensions

NMHS4-□ Φ50D/Φ63D

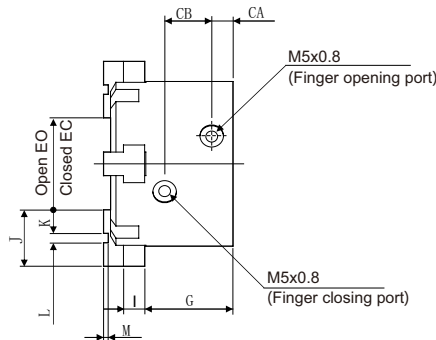
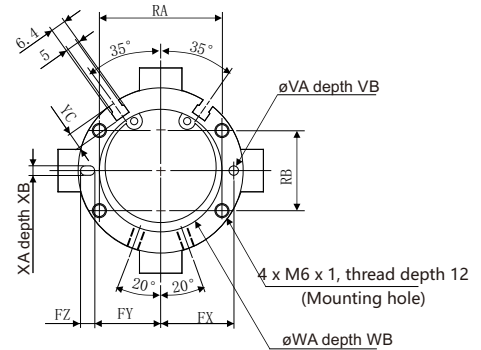
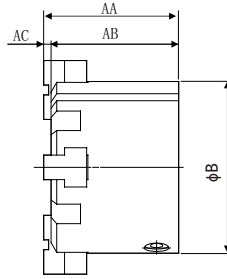
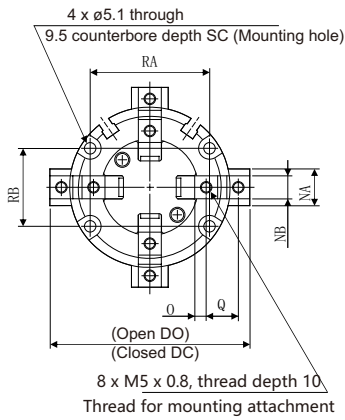

(mm)

Model	AA	AB	AC	B	CA	CB	DC	DO	EC	EO	FX	FY	FZ	G	I	J	K	L
NMHS4-50D	55	52	3	70	9	20	74	86	26	38	31	28	6	37.5	9	24	10	4H9 ^{+0.030} ₀
NMHS4-63D	66	62	4	86	12	22	91	107	35	51	38	34.5	7	44	11	28	11	6H9 ^{+0.030} ₀

Model	M	NA	NB	O	Q	RA	RB	SC	VA	VB	WA	WB	XA	XB	YG
NMHS4-50D	2	18	10h9 ⁰ _{-0.036}	5	14	52	34	12	4H9 ^{+0.030} ₀	4	52H9 ^{+0.074} ₀	2	4H9 ^{+0.030} ₀	4	7
NMHS4-63D	3	24	12h9 ⁰ _{-0.043}	5.5	17	66	38	14	5H9 ^{+0.030} ₀	5	65H9 ^{+0.074} ₀	2.5	5H9 ^{+0.030} ₀	5	7.5

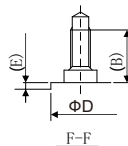
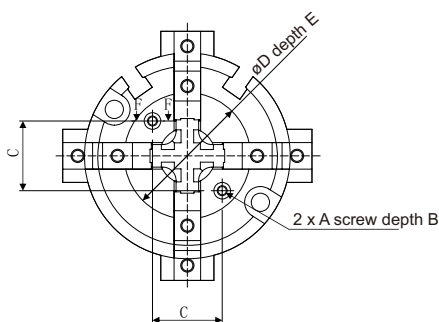

(mm)

Model	A	B	C	ΦD	E
NMHS4-16D	M2 x 0.4	5.5	11	21 ^{+0.1} ₀	0.5
NMHS4-20D		5.4	13	24 ^{+0.1} ₀	0.6
NMHS4-25D		5.2	15	27 ^{+0.1} ₀	0.8
NMHS4-32D	M3 x 0.5	8	18	32 ^{+0.1} ₀	1
NMHS4-40D		8	21	38 ^{+0.1} ₀	1
NMHS4-50D		8	24	42 ^{+0.1} ₀	1
NMHS4-63D		8	32	54 ^{+0.1} ₀	1